

**Macho manual, rosca métrica grossa, tolerância ISO 6H.**  
Metric hand taps, coarse threads.



**6101**



**6102**

	d1	P	L1	L2	d2	F	Nº de canais
	mm	mm	mm	mm	mm	mm	
M 3,0	3,0	0,5	40	11	3,5	2,7	3
M 4,0	4,0	0,7	45	13	4,5	3,4	3
M 5,0	5,0	0,8	50	16	6,0	4,9	3
M 6,0	6,0	1,0	56	19	6,0	4,9	3
M 7,0	7,0	1,0	56	19	6,0	4,9	3
M 8,0	8,0	1,25	63	22	6,0	4,9	4
M 10,0	10,0	1,5	70	24	7,0	5,5	4
M 12,0	12,0	1,75	75	28	9,0	7,0	4
M 14,0	14,0	2,0	80	30	11,0	9,0	4
M 16,0	16,0	2,0	80	32	12,0	9,0	4

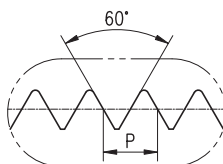

Detalhe do perfil da rosca

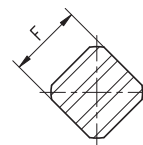

Corte AA  
(Quadrado de arraste)

